

The Global Water Submersible Sump Pump range provides a dependable solution for pumping drainage water, stormwater and wastewater containing solids for commercial, building services and industrial applications.

Single phase units are fitted with float switches for fully automatic operation and have in-built overload protection. Both single and three phase units can handle water with temperatures up to 40 °C continuous duty and 60 °C intermittent duty.

The GPD Series are all-stainless steel construction, fitted with 5 m electric cables. Units have a semi-open impeller that will pass 10 mm solids - ideal for greywater or stormwater applications.

The GPV Series are heavy duty units constructed from cast iron and stainless steel for durability and corrosion resistance, with either single or three phase electric motor. A 10 m power cable comes as standard.

All GPV pumps are fitted with vortex or channel impellers to enable the handling of suspended solids up to 75 mm in diameter.

Larger flow rate units and hazardous area units rated for Class 1 Zone 2 are available on request.



Technical data

| Pump model | Power (kW) | Current (A) | Voltage (V) | Outlet (mm) | Ø Solids (mm) |
|------------|------------|-------------|-------------|-------------|---------------|
| GPD32-25 | 0.25 | 1.9 | 240 | 32 | 10 |
| GPD32-55 | 0.55 | 3.6 | 240 | 32 | 10 |
| GPV40-75 | 0.75 | 4.8 | 240 | 40 | 40 |
| GPV40-110 | 1.1 | 6.9 | 240 | 40 | 40 |
| GPV50-110 | 1.1 | 7.8 | 240 | 50 | 50 |
| GPV50-111 | 1.1 | 6.9 | 240 | 50 | 50 |
| GPV65-180 | 1.8 | 11.6 | 240 | 65 | 60 |
| GPV80-150 | 1.5 | 13.0 | 240 | 80 | 60 |
| GPV50-180 | 1.8 | 4.1 | 415 | 50 | 40 |
| GPV65-200 | 2.0 | 4.6 | 415 | 65 | 60 |
| GPV80-220 | 2.2 | 6.5 | 415 | 80 | 65 |
| GPV80-300 | 3.0 | 7.5 | 415 | 80 | 65 |
| GPV100-550 | 5.5 | 12.3 | 415 | 100 | 80 |
| GPV100-750 | 7.5 | 16.5 | 415 | 100 | 80 |

Performance curve

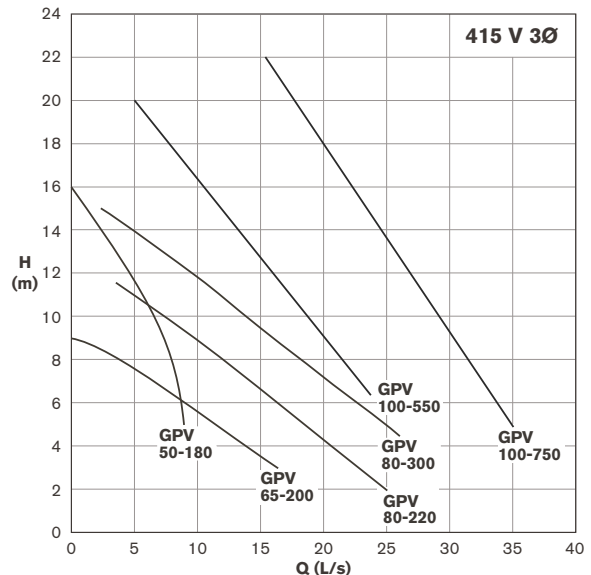
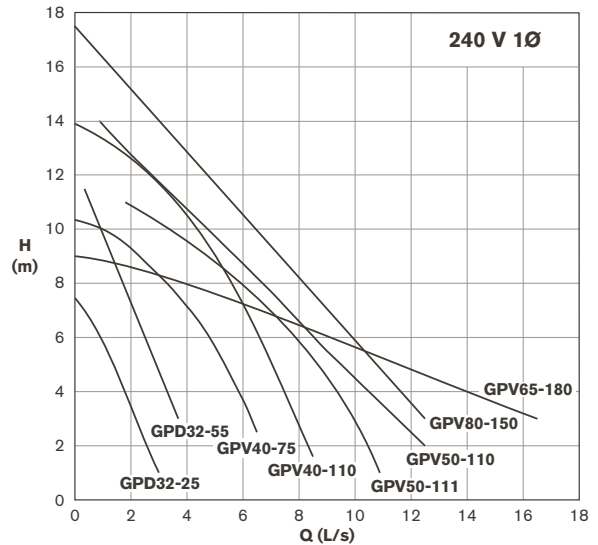

Suitable for small stormwater discharge and emptying small flooded areas (rooms, cellars, garages), for the disposal of domestic wastewater (i.e. dishwashers, washing machines) and emptying sludge chambers, sub-soil drainage pits and septic tanks.

Features

- Constructed from corrosion resistant 304 stainless steel.
- Oil lubricated double mechanical shaft seal.
- Air-filled, continuous duty motors rated for up to 20 starts per hour.
- Built-in thermal protection with automatic reset.



Dimensions (all measurements mm)

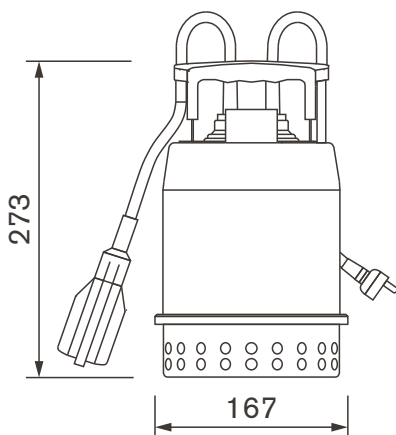

Technical data

| | |
|----------------------|---------------------|
| Outlet (mm) | 32 BSP |
| Max flow rate (L/s) | 2.5 |
| Max head (m) | 7.0 |
| Max liquid temp (°C) | 50 |
| Ø Solids (mm) | 10 |
| Power (kW) | 0.25 |
| Current (A) | 1.9 |
| Voltage (V) | 240 |
| Speed (RPM) | 2900 |
| Casing | Stainless steel |
| Impeller | PPE |
| Motor housing | Stainless steel |
| Protection | IP68 |
| Cable details | 5 m length, H05RN-F |
| Mounting | Free-standing only |
| Weight (kg) | 4.4 |

Performance curve

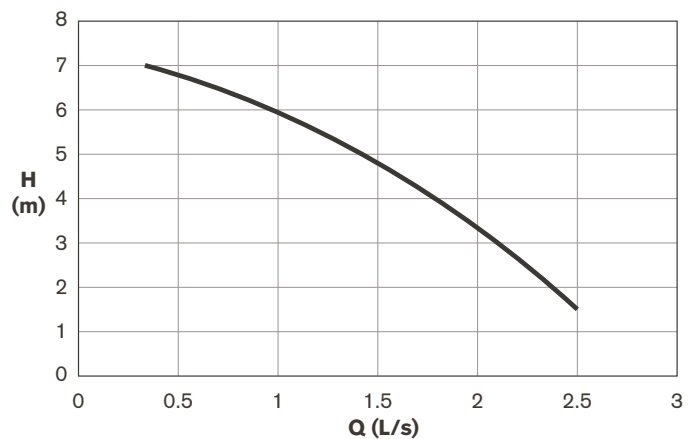

Suitable for small stormwater discharge and emptying small flooded areas (rooms, cellars, garages), for the disposal of domestic wastewater (i.e. dishwashers, washing machines) and emptying sludge chambers, sub-soil drainage pits and septic tanks.

Features

- Constructed from corrosion resistant 304 stainless steel.
- Oil lubricated double mechanical shaft seal.
- Air-filled, continuous duty motors rated for up to 20 starts per hour.
- Built-in thermal protection with automatic reset.



Dimensions (all measurements mm)

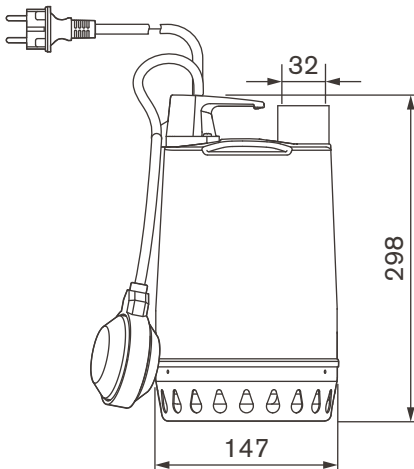

Technical data

| | |
|----------------------|----------------------|
| Outlet (mm) | 32 BSP |
| Max flow rate (L/s) | 3.6 |
| Max head (m) | 11.5 |
| Max liquid temp (°C) | 50 |
| Ø Solids (mm) | 10 |
| Power (kW) | 0.55 |
| Current (A) | 3.6 |
| Voltage (V) | 240 |
| Speed (RPM) | 2900 |
| Casing | Stainless steel |
| Impeller | Stainless steel |
| Motor housing | Stainless steel |
| Protection | IP68 |
| Cable details | 10 m length, H07RN-F |
| Mounting | Free-standing only |
| Weight (kg) | 7.6 |

Performance curve

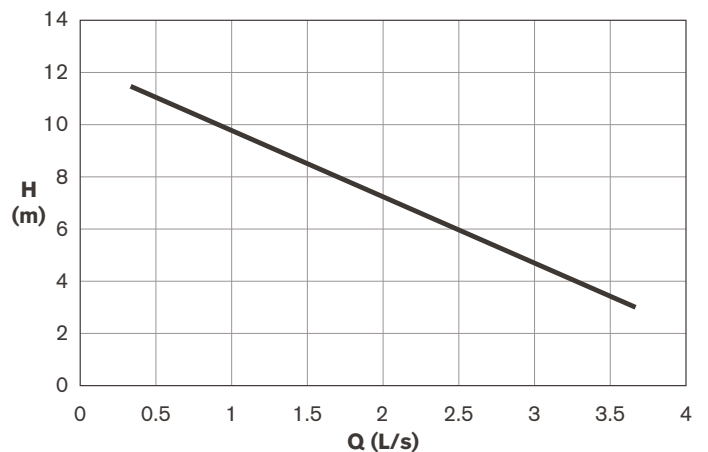

Ideal for pumping effluent, stormwater run-off and contaminated drainage water in light commercial applications, particularly where there is the likelihood of solids or stringy material.



Dimensions (all measurements mm)

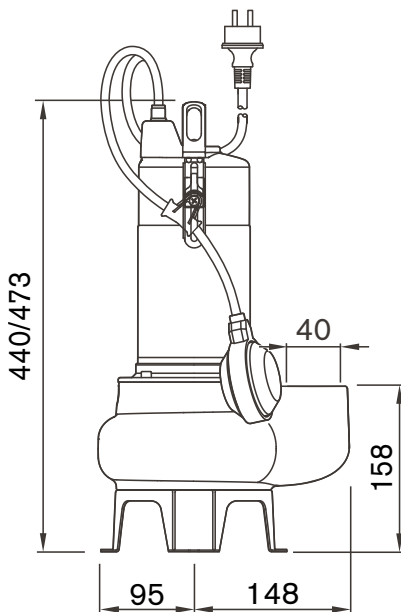

Technical data

| Model GPV | 40-75 | 40-110 |
|----------------------|--------------------------------|--------|
| Outlet (mm) | 40 BSP | |
| Max flow rate (L/s) | 6.6 | 8.3 |
| Max head (m) | 10 | 13.5 |
| Max liquid temp (°C) | 40 | |
| Ø Solids (mm) | 40 | |
| Power (kW) | 0.75 | 1.1 |
| Current (A) | 4.8 | 6.9 |
| Voltage (V) | 240 | |
| Speed (RPM) | 2900 | |
| Casing | Epoxy electro coated cast iron | |
| Impeller | Stainless vortex | |
| Motor housing | Stainless steel | |
| Protection | IP68 | |
| Cable details | 10 m length, H07RN-F | |
| Mounting | Free-standing only | |
| Weight (kg) | 15.2 | 18.0 |

Performance curve

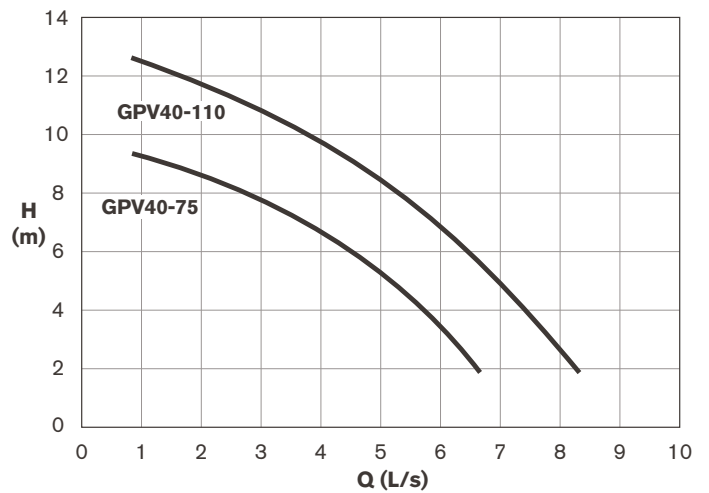

Ideal for pumping effluent, stormwater run-off and contaminated drainage water in light commercial applications, particularly where there is the likelihood of solids or stringy material.



Technical data

| | |
|----------------------|--------------------------------|
| Outlet (mm) | 50 BSP |
| Max flow rate (L/s) | 12.5 |
| Max head (m) | 14 |
| Max liquid temp (°C) | 40 |
| Ø Solids (mm) | 50 |
| Power (kW) | 1.1 |
| Current (A) | 7.8 |
| Voltage (V) | 240 |
| Speed (RPM) | 2900 |
| Casing | Epoxy electro coated cast iron |
| Impeller | Stainless open-type |
| Motor housing | Stainless steel |
| Protection | IP68 |
| Cable details | 10 m length, H07RN-F |
| Mounting | Free-standing only |
| Weight (kg) | 18.8 |

Dimensions (all measurements mm)

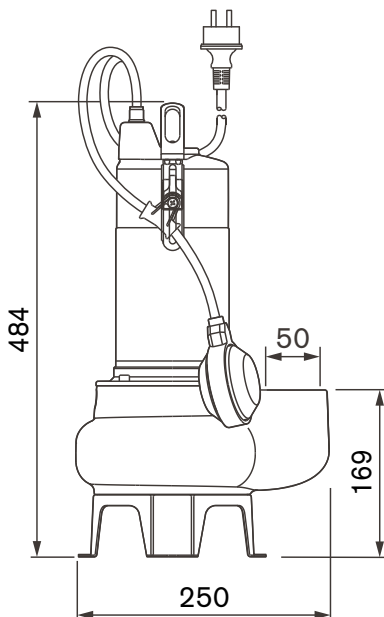

Performance curve

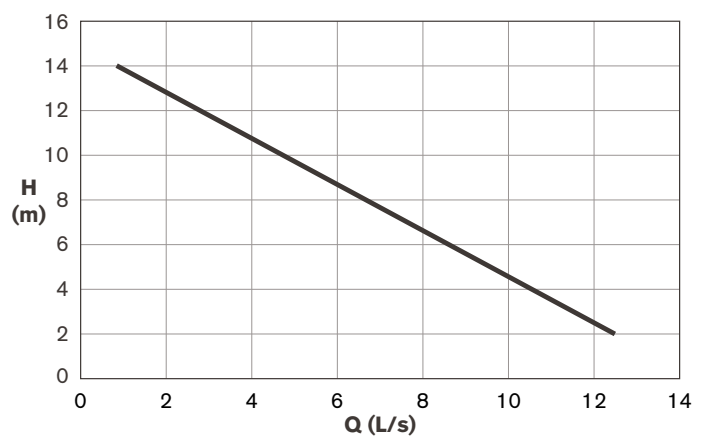

Ideal for pumping effluent, stormwater run-off and contaminated drainage water in light commercial applications, particularly where there is the likelihood of solids or stringy material.



Technical data

| | |
|----------------------|--------------------------------|
| Outlet (mm) | 50 BSP |
| Max flow rate (L/s) | 10.8 |
| Max head (m) | 11 |
| Max liquid temp (°C) | 40 |
| Ø Solids (mm) | 50 |
| Power (kW) | 1.1 |
| Current (A) | 6.9 |
| Voltage (V) | 240 |
| Speed (RPM) | 2900 |
| Casing | Epoxy electro coated cast iron |
| Impeller | Stainless vortex |
| Motor housing | Stainless steel |
| Protection | IP68 |
| Cable details | 10 m length, H07RN-F |
| Mounting | Free-standing only |
| Weight (kg) | 18.5 |

Dimensions (all measurements mm)

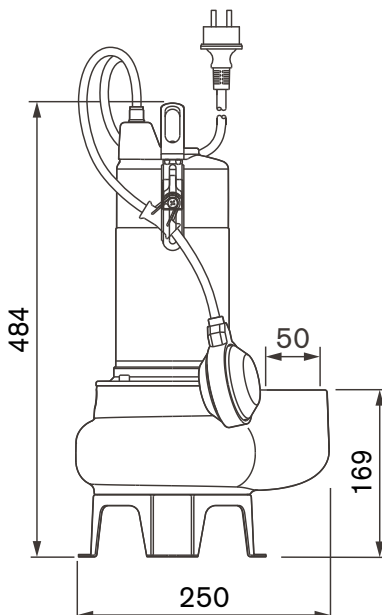

Performance curve

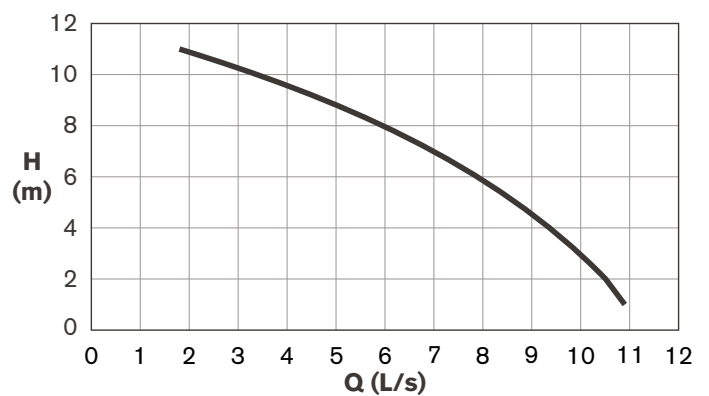

Designed for larger commercial and industrial applications, this pump is ideal for trouble-free pumping of effluent, wash-down and stormwater in commercial and industrial applications, particularly where solids and stringy material need to be handled.

Units are fitted with a powerful single-phase or 3-phase motor incorporating an EasyFit plug-in cable for simple disconnection and replacement.

GPV65-180 single-phase unit comes with an automatic float switch.



Dimensions (all measurements mm)

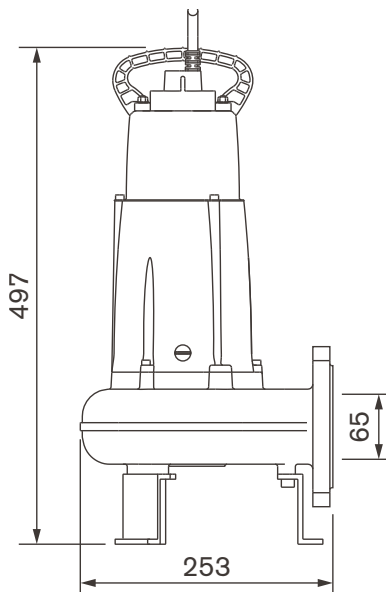

GP Series Submersible Sump Pumps

GPV65-180 single-phase

GPV65-200 3-phase

Technical data

| Model GPV | 65-180 | 65-200 |
|----------------------|------------------------------|--------|
| Outlet (mm) | 65 DIN flange | |
| Max flow rate (L/s) | 15.4 | |
| Max head (m) | 8.1 | |
| Max liquid temp (°C) | 40 | |
| Ø Solids (mm) | 60 | |
| Power (kW) | 1.8 | 2 |
| Current (A) | 11.6 | 4.6 |
| Voltage (V) | 240 | 415 |
| Speed (RPM) | 2900 | |
| Casing | Cast iron | |
| Impeller | Polyamide vortex | |
| Motor housing | Stainless steel | |
| Protection | IP68 | |
| Cable details | 10 m length, H07RN8-F | |
| Mounting | Free-standing or guide rails | |
| Weight (kg) | 24 | |

Performance curve

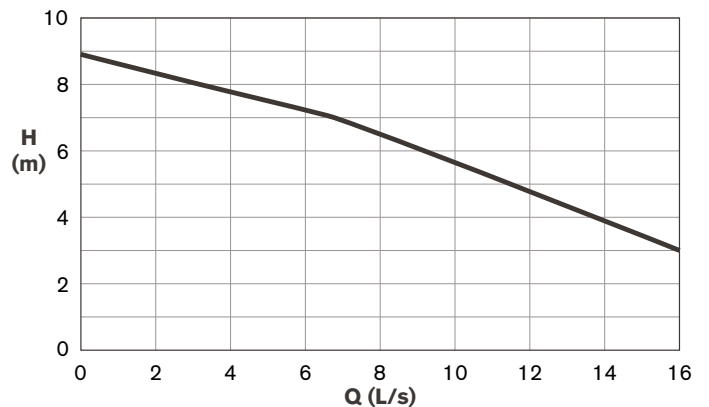

This heavy-duty pump is fitted with a large single-phase motor and is ideal for pumping sewage, wastewater, groundwater and stormwater in locations such as blocks of flats, public buildings, factories, car parks and washdown areas. Available either as freestanding or on guide rails, unit is constructed from cast-iron with a stainless steel motor housing, and is fitted with a single channel open impeller (60 mm solids) and a dual oil lubricated mechanical seal.

The pump is available with an optional automatic float switch, and the motor is fitted with thermal overload protection. For corrosive applications, unit is available in all 316 stainless steel construction for ultimate corrosion resistance.



Dimensions (all measurements mm)

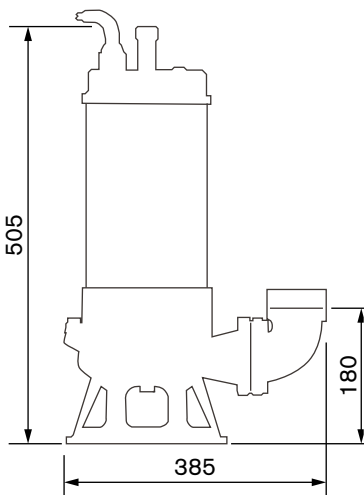

Technical data

| | |
|----------------------|------------------------------|
| Outlet (mm) | 80 BSP flanged bend |
| Max flow rate (L/s) | 12.5 |
| Max head (m) | 17.5 |
| Max liquid temp (°C) | 40 |
| Ø Solids (mm) | 60 |
| Power (kW) | 1.5 |
| Current (A) | 13.0 |
| Voltage (V) | 240 |
| Speed (RPM) | 2850 |
| Casing | Cast iron |
| Impeller | Cast iron |
| Motor housing | Stainless steel |
| Protection | IP68 |
| Cable details | 10 m length, H07 RN-F |
| Mounting | Free standing or guide rails |
| Weight (kg) | 41 |

Performance curve

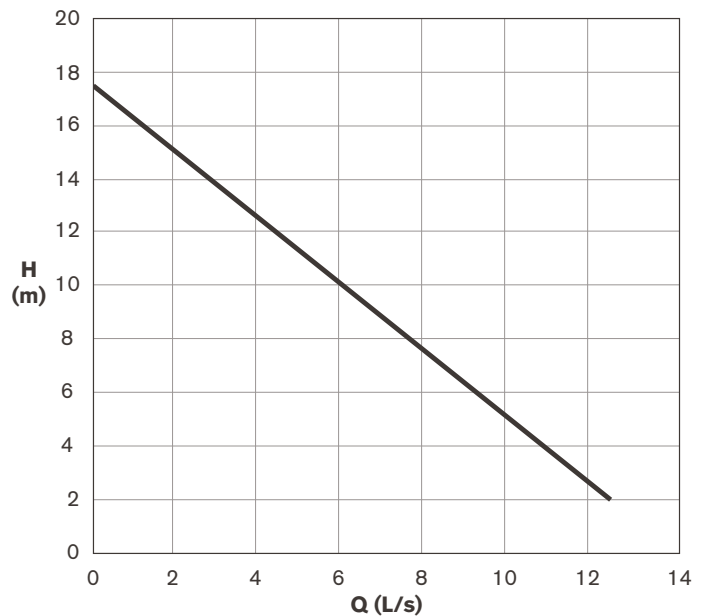

Designed for larger commercial and industrial applications, this pump is ideal for trouble-free pumping of effluent, wash-down and stormwater in commercial and industrial applications, particularly where solids and stringy material need to be handled.

Units are fitted with a powerful 1.8 kW 3-phase motor incorporating an EasyFit plug-in cable for simple disconnection and replacement.



Technical data

| | |
|----------------------|------------------------------|
| Outlet (mm) | 50 BSP |
| Max flow rate (L/s) | 9 |
| Max head (m) | 16 |
| Max liquid temp (°C) | 40 |
| Ø Solids (mm) | 40 |
| Power (kW) | 1.8 |
| Current (A) | 4.1 |
| Voltage (V) | 415 |
| Speed (RPM) | 2900 |
| Casing | Cast iron |
| Impeller | Polyamide vortex |
| Motor housing | Stainless steel |
| Protection | IP68 |
| Cable details | 10 m length, H07RN8-F |
| Mounting | Free-standing or guide rails |
| Weight (kg) | 20 |

Dimensions (all measurements mm)

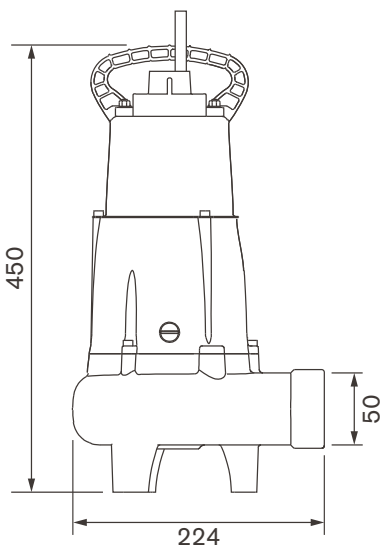

Performance curve

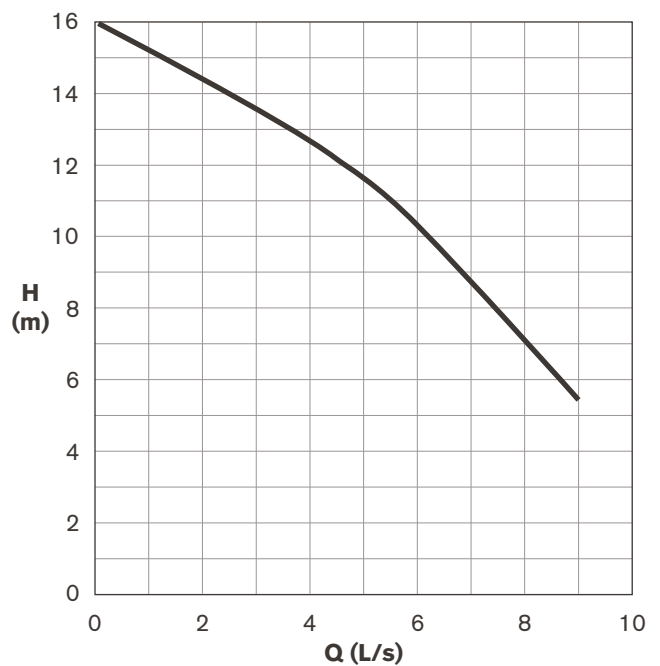

This heavy-duty range is fitted with three-phase motors and is ideal for pumping sewage, wastewater, groundwater and stormwater in locations such as blocks of flats, public buildings, factories, car parks and washdown areas. Units are constructed from cast iron, fitted with an open-type stainless impeller and dual oil lubricated mechanical seal.

A thermostat for over-temperature protection is fitted in the motor windings.



Dimensions (all measurements mm)

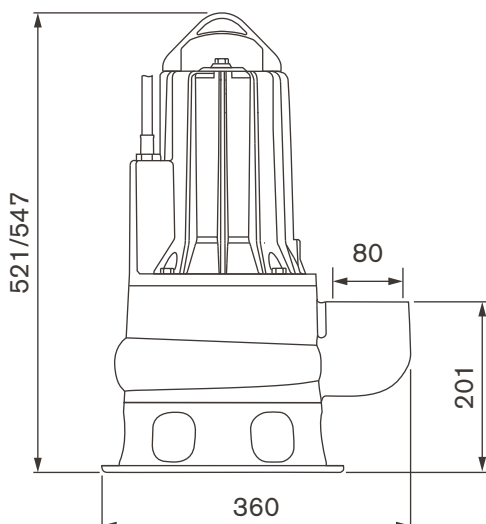

Technical data

| Model GPV | 80-220 | 80-300 |
|----------------------|--------------------------------|--------|
| Outlet (mm) | 80 BSP | |
| Max flow rate (L/s) | 25 | 26.6 |
| Max head (m) | 12 | 15 |
| Max liquid temp (°C) | 40 | |
| Ø Solids (mm) | 65 | |
| Power (kW) | 2.2 | 3.0 |
| Current (A) | 6.5 | 7.5 |
| Voltage (V) | 415 | |
| Speed (RPM) | 2900 | |
| Casing | Epoxy electro coated cast iron | |
| Impeller | Stainless open-type | |
| Motor housing | Epoxy electro coated cast iron | |
| Protection | IP68 | |
| Cable details | 10 m length, H07 RN-F | |
| Mounting | Free-standing only | |
| Weight (kg) | 45 | 50 |

Performance curve

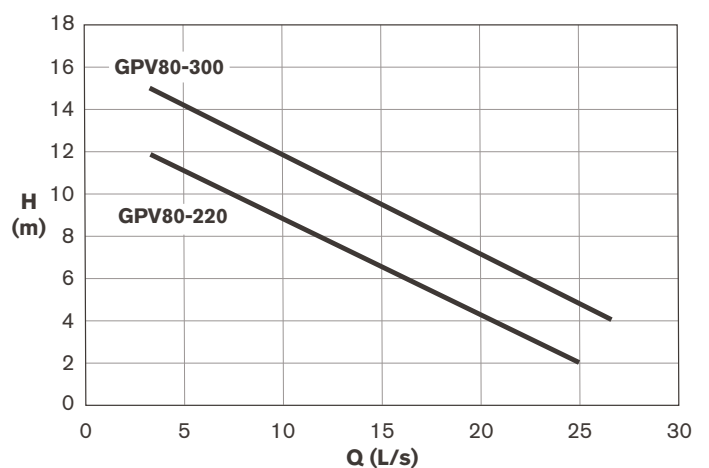

These heavy-duty pumps are fitted with large three-phase motors and are ideal for handling sewage, wastewater, groundwater, stormwater, light slurries, and factory waste in locations such as apartment blocks, public buildings, factories, car parks, and washdown areas. Constructed from cast iron with stainless steel motor housings, the units feature a single-channel open impeller (80 mm solids) and are supplied with a discharge pedestal and sliding guide rail kit for easy mounting.

The pumps include double mechanical shaft seals in an oil bath, with hard-faced silicon carbide/ceramic seals on the pump side, providing superior motor protection and extended service life. They also feature automatic resetting thermal overload protection to prevent overloading. For corrosive environments, the units are available in all-316 stainless steel construction for maximum corrosion resistance.



Dimensions (all measurements mm)

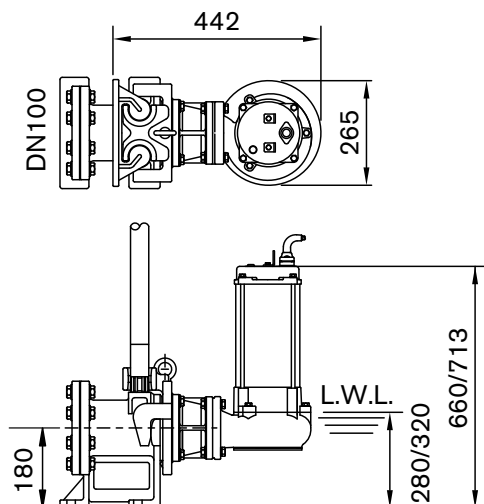

Technical data

| Model GPV | 100-550 | 100-750 |
|----------------------|-----------------------|---------|
| Outlet (mm) | 100 BSP flanged bend | |
| Max flow rate (L/s) | 25 | 36 |
| Max head (m) | 22.5 | 32.5 |
| Max liquid temp (°C) | 40 | |
| Ø Solids (mm) | 80 | |
| Power (kW) | 5.5 | 7.5 |
| Current (A) | 12.3 | 16.5 |
| Voltage (V) | 415 | |
| Speed (RPM) | 2850 | |
| Casing | Cast iron | |
| Impeller | Cast iron | |
| Motor housing | Stainless steel | |
| Protection | IP68 | |
| Cable details | 10 m length, H07 RN-F | |
| Mounting | Guide rails only | |
| Weight (kg) | 85 | 90 |

Performance curve

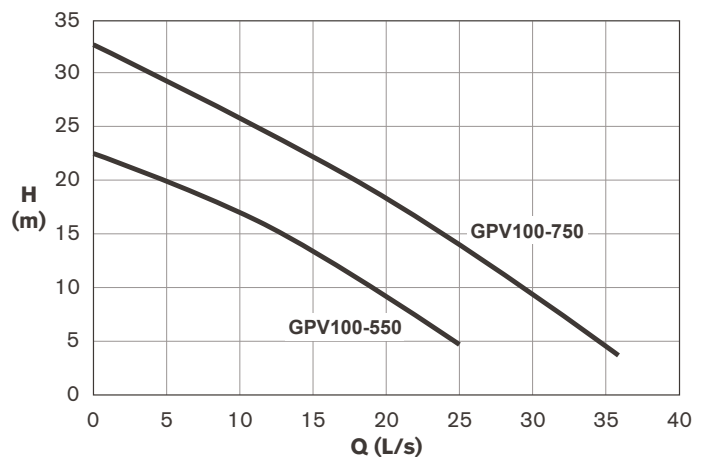

The GPVH Series Hazardous Area Submersible sump pumps are fitted with IEC Ex submersible motors suitable for use in undercroft and below ground car parks where Class 1 Zone 2 classification is required.

Features

- Rugged cast iron housing.
- Stainless steel shaft.
- 50 mm units have double silicon carbide seals.
- Available with in-built float switch.
- Vortex impeller for full-bore solids handling.



Dimensions (all measurements mm)

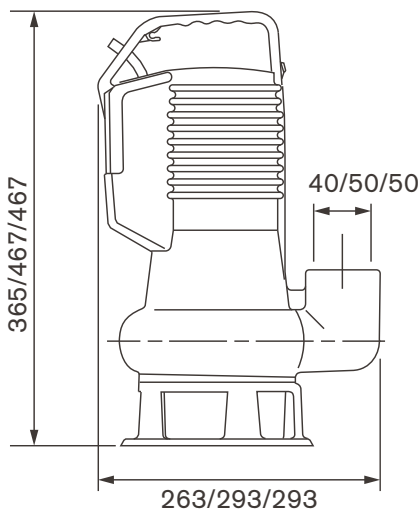

Technical data

| Model GPVH | 40-75 | 50-110 | 50-150 |
|----------------------|------------------------------|------------------|---------|
| Outlet (mm) | 40 BSP | 50 BSP | |
| Max flow rate (L/s) | 7.6 | 10.8 | 12.5 |
| Max head (m) | 11.4 | 11.5 | 14.5 |
| Max liquid temp (°C) | 40 | | |
| Ø Solids (mm) | 40 | 50 | 50 |
| Power (kW) | 0.75 | 1.1 | 1.5 |
| Current (A) | 5.6 | 7.5/3.2 | 10/4.3 |
| Voltage (V) | 240 | 240/415 | 240/415 |
| Speed (RPM) | 2900 | 2780 | 2750 |
| Casing | Cast iron | | |
| Impeller | Technopolymer vortex | Cast iron vortex | |
| Motor housing | Cast iron | | |
| Protection | IP68 IEC Ex | | |
| Cable details | 10 m length, 3G1 | | |
| Mounting | Free-standing or guide rails | | |
| Weight (kg) | 15.5 | 23 | 24 |

Performance curve

